

Solderless splices

WINDOW TYPE BUTT

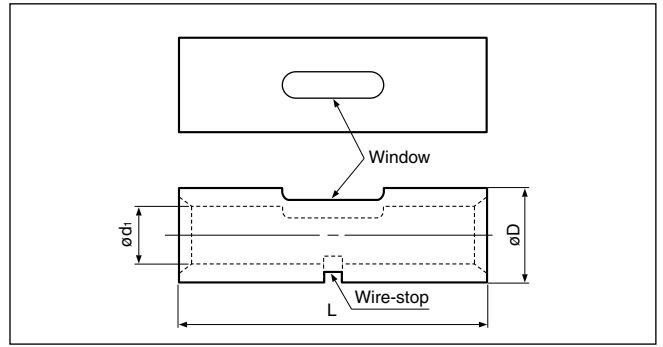

Non-insulated

| Applicable Wire AWG#(mm ²) | Part No. | Standard | Dimensions mm (in.) | | | Tool No. | | | | | | | | | | | Qty/box | | | | | | | | | |
|--|----------|----------|---------------------|-------------|------------------|----------|--------|------|------|------|------|---------|-----------|----------|----------|----------|---------|----------|-----------|-----------|----------|--|--|--|--|-------|
| | | | L | ø D | ø d ₁ | YHT-2210 | YHT-8S | YA-1 | YA-2 | YA-4 | YA-5 | YPT-60N | YPT-150-1 | BCT-0514 | BCT-860N | BCT-8150 | | YET-80-1 | YET-150-1 | YET-300-1 | YET-300N | | | | | |
| 22 to 16 (0.25 to 1.65) | CW-1.25 | | 14.7 (.579) | 3.3 (.130) | 1.7 (.067) | o | | o | o | o | | | | | o | | | | | | | | | | | 1,000 |
| 16 to 14 (1.04 to 2.63) | CW-2 | | 14.7 (.579) | 4.0 (.157) | 2.3 (.091) | o | | o | o | o | | | | | o | | | | | | | | | | | 1,000 |
| 12 to 10 (2.63 to 6.64) | CW-5.5 | | 14.7 (.579) | 5.5 (.217) | 3.4 (.134) | o | | o | o | o | | | | | o | | | | | | | | | | | 500 |
| 8 (6.64 to 10.52) | CW-8 | | 21.0 (.827) | 7.1 (.280) | 4.5 (.177) | | o | | | o | o | o | o | o | o | o | o | o | o | | | | | | | 200 |
| 6 (10.52 to 16.78) | CW-14 | | 26.0(1.024) | 9.0 (.354) | 5.8 (.228) | | | | | o | o | o | o | o | o | o | o | o | o | | | | | | | 100 |
| 4 (16.78 to 26.66) | CW-22 | | 29.0(1.142) | 11.4 (.449) | 7.7 (.303) | | | | | o | o | o | o | o | o | o | o | o | o | | | | | | | 50 |
| 2 (26.66 to 42.42) | CW-38 | | 32.0(1.266) | 13.3 (.524) | 9.4 (.370) | | | | | o | o | o | o | o | o | o | o | o | o | | | | | | | 25 |
| 1/0 (42.42 to 60.57) | CW-60 | | 36.0(1.417) | 15.4 (.606) | 11.4 (.449) | | | | | o | o | o | o | o | o | o | o | o | o | | | | | | | 20 |
| 2/0 (60.57 to 76.28) | CW-70 | | 37.0(1.457) | 17.5 (.689) | 13.3 (.524) | | | | | o | o | o | o | o | o | o | o | o | o | | | | | | | 10 |
| 3/0 (76.28 to 96.3) | CW-80 | | 38.0(1.496) | 19.4 (.764) | 14.5 (.571) | | | | | o | o | o | o | o | o | o | o | o | o | | | | | | | 10 |
| 4/0 (96.3 to 117.2) | CW-100 | | 38.0(1.496) | 22.0 (.866) | 16.4 (.646) | | | | | o | o | o | o | o | o | o | o | o | o | | | | | | | 10 |
| 250 to 300MCM (117.2 to 152.05) | CW-150 | | 54.0(2.126) | 26.5(1.043) | 19.5 (.768) | | | | | o | o | o | o | o | o | o | o | o | o | | | | | | | |
| 350MCM (152.05 to 192.6) | CW-180 | | 57.0(2.244) | 28.5(1.122) | 21.0 (.827) | | | | | | | | | | | | | | | | | | | | | |
| 400MCM (192.6 to 242.27) | CW-200 | | 63.0(2.480) | 32.5(1.280) | 24.0 (.945) | | | | | | | | | | | | | | | | | | | | | |
| 600 to 650MCM (242.27 to 325) | CW-325 | | 72.0(2.835) | 37.0(1.457) | 28.0(1.102) | | | | | | | | | | | | | | | | | | | | | |

Note:1) Delivery lead times may vary depending on the product. Contact JST for details.

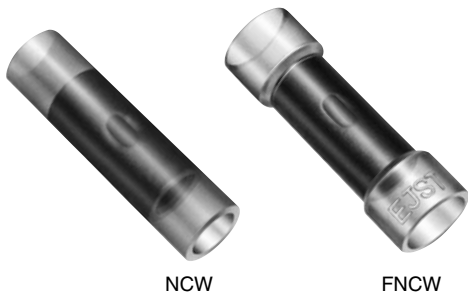

NCW

FNCW

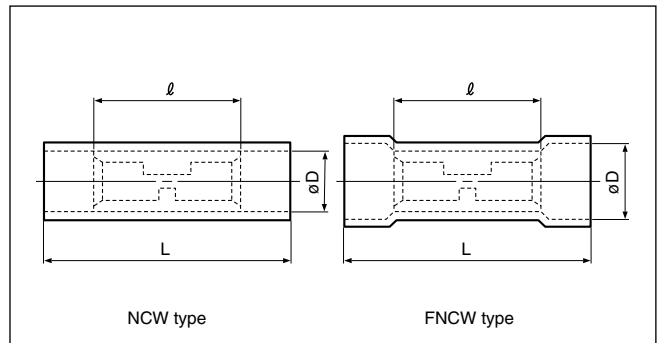

Nylon-insulated

| Applicable Wire AWG#(mm ²) | Part No. | Standard | Dimensions mm (in.) | | | Color | Tool No. | | | | | | Qty/box | | | | |
|--|-----------|------------|---------------------|-------------|------------|----------------|----------|----------|-----------|------|------|------|---------|----------|---|--|--|
| | | | L | l | ø D | | YNT-2216 | YNT-1614 | YNT-1210S | YA-1 | YA-2 | YA-4 | | BCT-0514 | | | |
| 22 to 16 *(0.25 to 1.65) | NCW-1.25 | | 22.7 (.894) | 14.7 (.579) | 3.2 (.126) | Red (Clear) | o | | | | o | o | o | o | o | | |
| | FNCW-1.25 | 4.0 (.157) | | | | | | | | | | | | | | | |
| 16 to 14 (1.04 to 2.63) | NCW-2 | | 22.7 (.894) | 14.7 (.579) | 3.9 (.154) | Blue (Clear) | | o | | | | o | o | o | o | | |
| | FNCW-2 | 4.5 (.177) | | | | | | | | | | | | | | | |
| 12 to 10 (2.63 to 6.64) | NCW-5.5 | | 26.7(1.051) | 14.7 (.579) | 5.4 (.213) | Yellow (Clear) | | | | | o | | | o | o | | |
| | FNCW-5.5 | 6.8 (.268) | | | | | | | | | | | | | | | |

Note:1) *The crimping will be more secure if the total cross-sectional area of the wire is at least 0.5 mm².
 Examples: If the cross-sectional area of the wire is 0.3mm², fold the wire in two when crimping the terminal.
 If the cross-sectional area of the wire is 0.5mm², crimp the terminal onto the wire as it is.
 2) The insulation is colored transparent nylon so that the wire inside the sleeve is visible.
 3) Delivery lead times may vary depending on the product. Contact JST for details.

Solderless splices

WINDOW TYPE BUTT

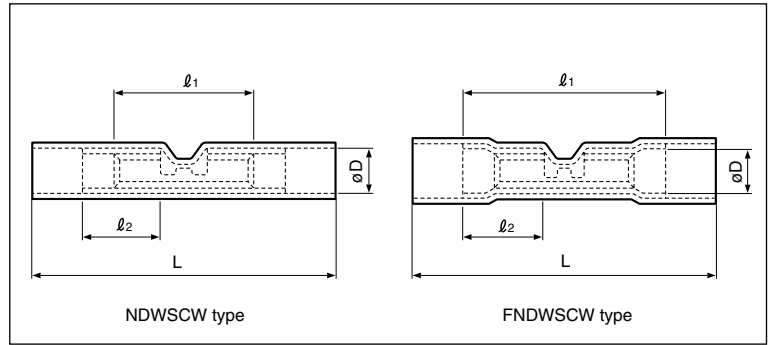
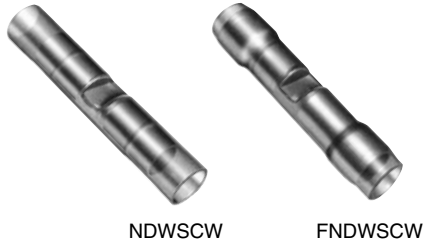

Nylon-insulated with copper sleeve

| Applicable Wire AWG#(mm ²) | Part No. | Standard | Dimensions mm (in.) | | | | Color | Tool No. | | | | | | Qty/box | |
|---|--------------|----------|---------------------|-------------|------------|-------------|----------------|----------|----------|-----------|------|------|------|---------|----------|
| | | | L | l_1 | ϕD | l_2 | | YNT-2216 | YNT-1614 | YNT-1210S | YA-1 | YA-2 | YA-4 | | BCT-0514 |
| 22 to 16 *(0.25 to 1.65) | NDWSCW-1.25 | | 31.5(1.240) | 14.6 (.575) | 3.5 (.138) | 8.3 (.327) | Red (Clear) | 0 | | | 0 | 0 | 0 | 0 | 1,000 |
| | FNDWSCW-1.25 | | 31.0(1.220) | 14.6 (.575) | 4.0 (.157) | 12.2 (.480) | | 0 | | | 0 | 0 | 0 | | |
| 16 to 14 (1.04 to 2.63) | NDWSCW-2 | | 31.5(1.240) | 14.6 (.575) | 4.1 (.161) | 8.3 (.327) | Blue (Clear) | | 0 | | 0 | 0 | 0 | 0 | 1,000 |
| | FNDWSCW-2 | | 31.0(1.220) | 14.6 (.575) | 4.7 (.185) | 12.2 (.480) | | | | | 0 | 0 | 0 | 0 | 500 |
| 12 to 10 (2.63 to 6.64) | NDWSCW-5.5 | | 41.1(1.618) | 19.5 (.768) | 5.7 (.224) | 12.0 (.472) | Yellow (Clear) | | | 0 | | | 0 | 0 | 500 |
| | FNDWSCW-5.5 | | 36.0(1.417) | 19.5 (.768) | 6.5 (.256) | 14.3 (.563) | | | | | | | 0 | 0 | 250 |

Note:1) These products have a butted seam.

2) *The crimping will be more secure if the total cross-sectional area of the wire is at least 0.5 mm².

Examples: If the cross-sectional area of the wire is 0.3mm², fold the wire in two when crimping the terminal.

If the cross-sectional area of the wire is 0.5mm², crimp the terminal onto the wire as it is.

3) Delivery lead times may vary depending on the product. Contact JST for details.