

# CFF CONNECTOR

1.27 mm pitch/CFast™ card standard-compliant

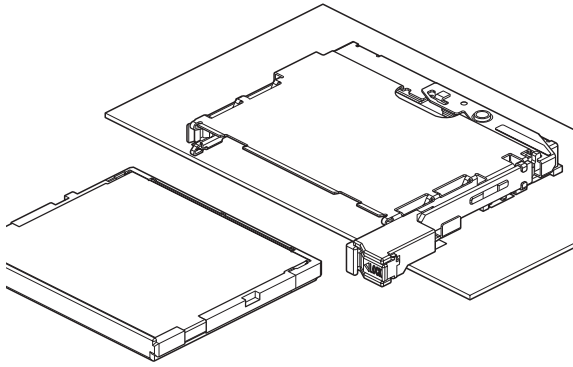

This is a connector for CFast™ Card compliant with the CFast™ Specification.

- Compliant with CFast™ Card Standard
- Stable transmission characteristic
- Card connector with GND spring
- Ejector with slide lock

## ■ Specifications

- Temperature range: -40°C to +85°C  
(including temperature rise in applying electrical current)
  - Contact resistance: Initial value/ 30 mΩ max.  
After environmental tests/ 15 mΩ max.  
(variation from initial value)
  - Withstanding voltage: There shall be no breakdown or flashover while applying 500 VAC for one minute.
  - Insulation resistance: 1,000 MΩ min. 500 VDC
  - Repeated mating/unmating performance: 10,000 cycles
- \* In using the products, refer to "Handling Precautions for Terminals and Connectors" described on our website (Technical documents of Product information page).
- \* RoHS2 compliance
- \* Dimensional unit: mm
- \* Contact JST for details.

## Card connector

- Offset -0.25 mm (With GND spring)

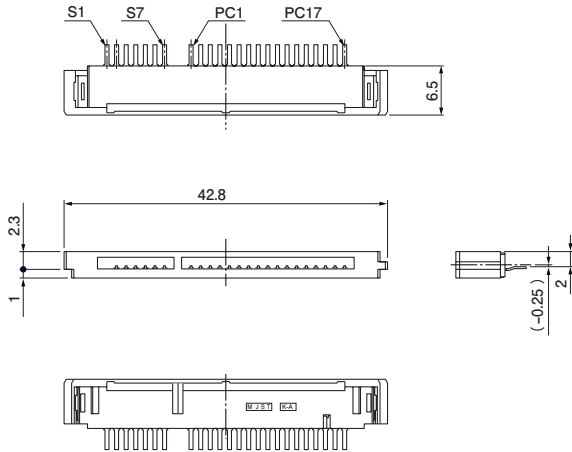

No. of circuits	Offset dimensions	GND spring	Model No.	Q'ty /reel
24	-0.25 mm	With GND spring	CFF-CC24S-1521-GB25T	1,500

### Material and Surface finish, etc.

Contact: Copper alloy	Mating part: gold-plated
Grounding spring: Copper alloy	Solder tail: tin-plated
Housing: LCP, black	Mating part: gold-plated

This product displays (LF) (SN) on a label.

Note: For flame retardant grade of resin material used, please refer to the "List of Registered Overseas Standards" on our website (listed in the "Technical Documents" column on the Product Information page).

## Top cover for Type I card

### Snap-in type

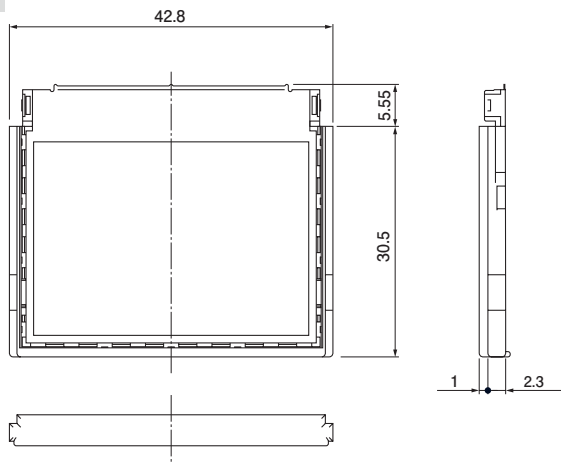

Type	Model No.	Q'ty/box
Snap-in type	CFF-FT1S-11FM	1,344

### Material and Surface finish, etc.

Top cover : Stainless steel,	Insulation film: PET
Frame: LCP, black	

Note: For flame retardant grade of resin material used, please refer to the "List of Registered Overseas Standards" on our website (listed in the "Technical Documents" column on the Product Information page).

## Bottom cover

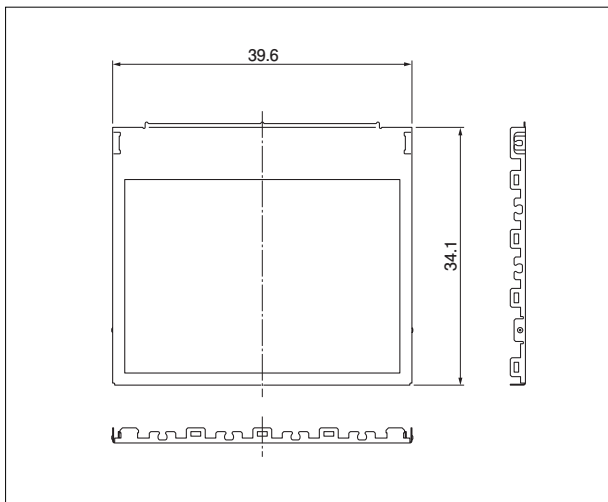

Type	Model No.	Q'ty/box
Snap-in type	CFF-FBU-12FM	1,344

### Material and Surface finish, etc.

Top cover : Stainless steel  
Insulation film: PET

Note: For flame retardant grade of resin material used, please refer to the "List of Registered Overseas Standards" on our website (listed in the "Technical Documents" column on the Product Information page).

## Card connector PC board layout

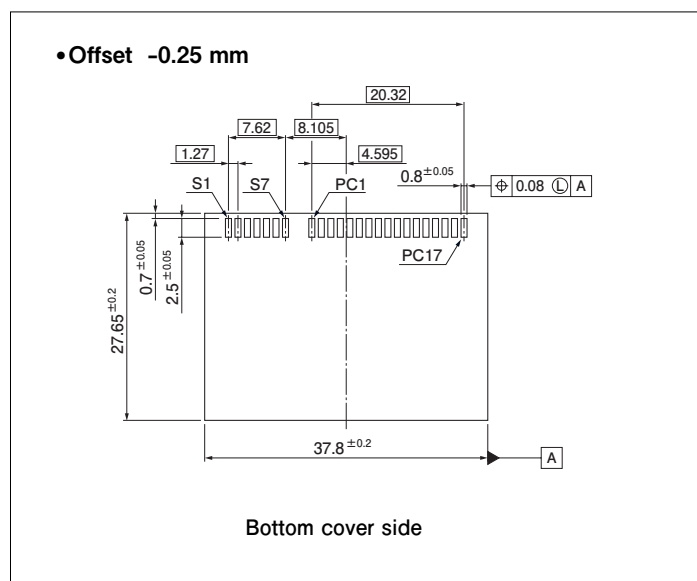

## Host connector

### Normal type

#### •Standoff 0 mm (With boss)

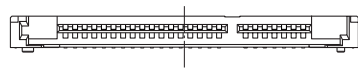
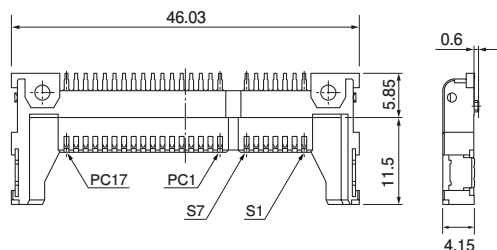

#### •Standoff 3 mm (Without boss)

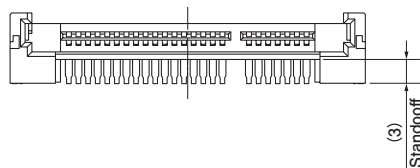
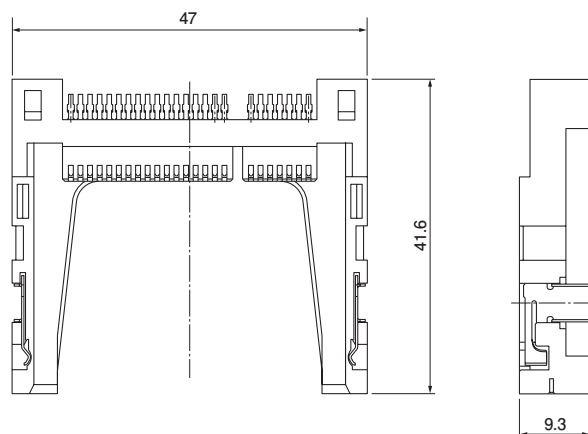

#### •Standoff 0 mm (Without boss)

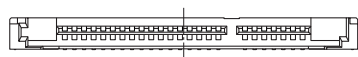
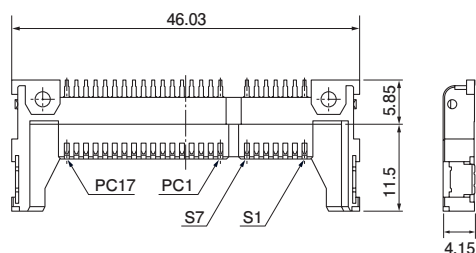

No. of circuits	Stand off	Polarizing boss	Model No.	Q'ty	Material and Surface finish, etc.
24	0 mm	With boss	CFF-HC24S-S352-N120T	700 (reel)	Contact: Copper alloy, Reinforcing tab: Copper alloy, tin-plated Housing: LCP, black Mating part: gold-plated Solder tail: tin-plated
			CFF-HC24S-S352-N120T1	100 (reel)	
	3 mm	Without boss	CFF-HC24S-S352-N130T	700 (reel)	
			CFF-HC24SG-S352-N133A	480 (box)	

This product displays (LF) (SN) on a label.

Note: For flame retardant grade of resin material used, please refer to the "List of Registered Overseas Standards" on our website (listed in the "Technical Documents" column on the Product Information page).

# CFF CONNECTOR

## Ejector

### Normal type

#### •Standoff 0 mm

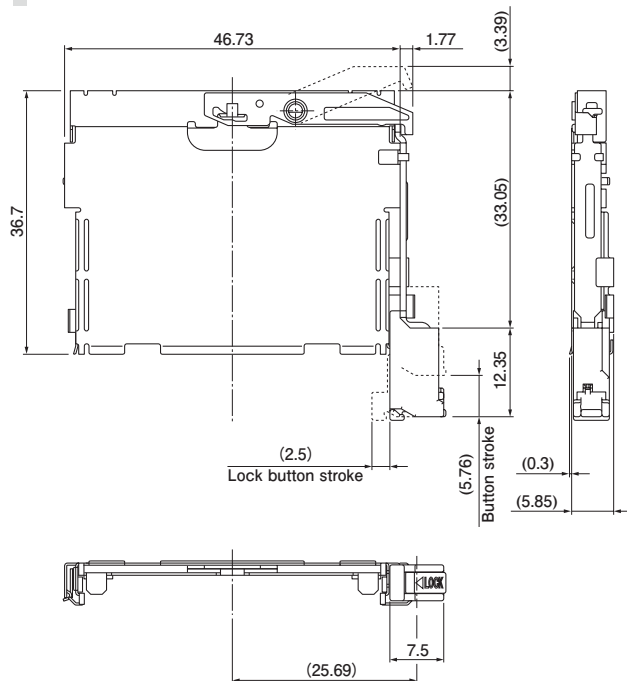

#### •Standoff 3 mm

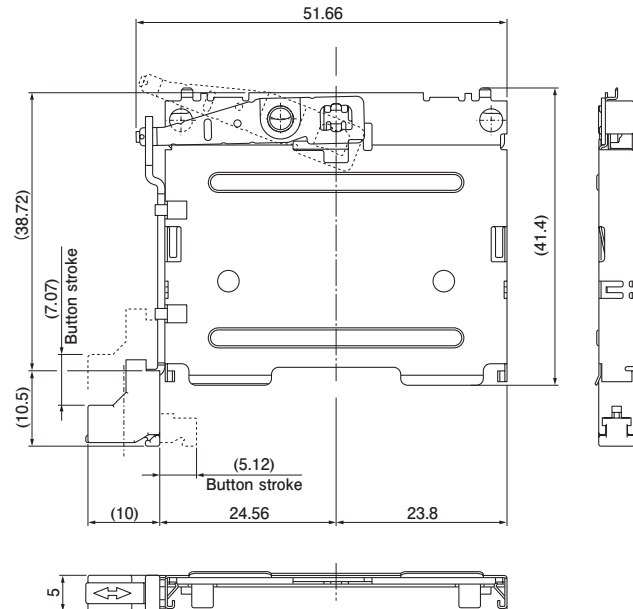

Standoff	Button position	Model No.	Q'ty/box	Material and Surface finish, etc.
0 mm	Right button	CFF-EP2R-NS11B	630	Frame: Stainless steel Standoff 0 mm type...Solder tail: tin-plated Push button: POM, black Lock button: POM, gray
		CFF-EP2R-NS11BR1	105	
3 mm	Left button	CFF-EP2L-NL10B	528	

Standoff 0 mm type product displays (LF) (SN) on a label.

Note: For flame retardant grade of resin material used, please refer to the "List of Registered Overseas Standards" on our website (listed in the "Technical Documents" column on the Product Information page).

## Hold cover

### Normal type

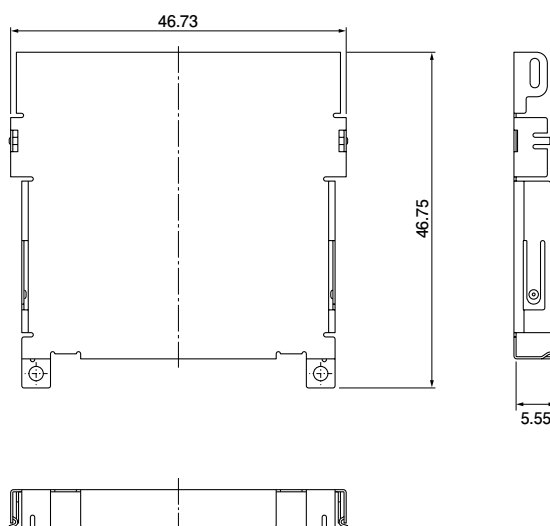

Standoff	GND spring	Model No.	Q'ty/box
0 mm	With GND spring	CFF-NE2-NS1CR1	120

#### Material and Surface finish, etc.

Frame: Stainless steel

- Standoff 0 mm (Without boss)

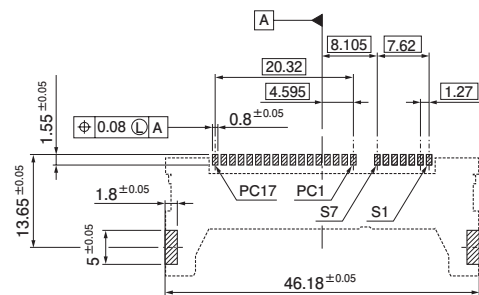

- Hold cover

### Standoff 0 mm (Without boss)

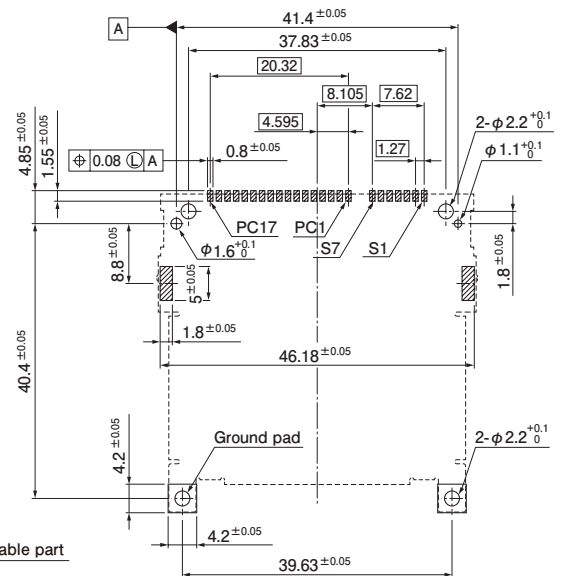

: Pattern and via hole prohibition area

- Ejector  
Standoff 3 mm

