

Developed in pursuit of miniaturization and waterproof as wire to wire type connector for automotive. To realize miniaturization and high reliability with the pitch 1.8mm and CPA design.

■ Features

- **Miniaturization**
0.50 terminal with 1.8mm pitch realized miniaturization.
- **Waterproof**
Mat seal is adopted for improving the workability of wire seal part.
- **Connector Position Assurance (CPA) Design**
- **UL94 V-0 material**
In response to increasingly stringent requirements for flammability. Use resin that supports UL94 V-0.

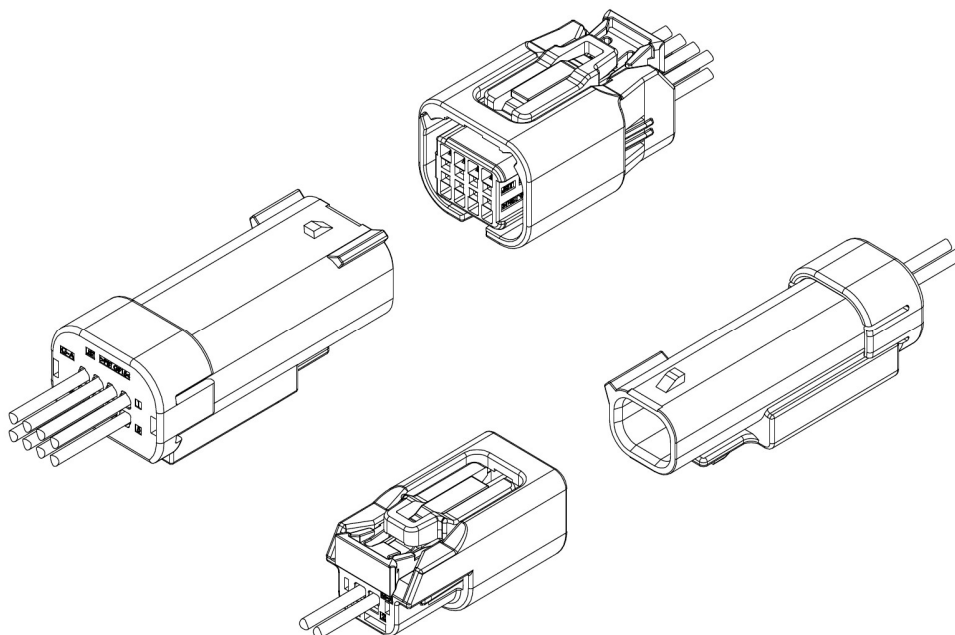

■ Specifications

- Current rating : 3A AC, DC max
- Withstanding voltage : 1,000 V AC / minute
- Temperature range : -40°C to +105°C
(including temperature rise in applying electrical current)
- Contact resistance : Initial value / 15 mΩ max.
After environmental tests / 15 mΩ max.
- Insulation resistance : 100 MΩ min.
- Applicable wire : 0.22mm² to 0.35mm², O.D. Ø1.0 to 1.2mm
(FLRY-A 0.22mm², CIVUS 0.35mm²)

*Compliant with ELV/RoHS.

*Contact JST for details.

Female terminal

● Female terminal M

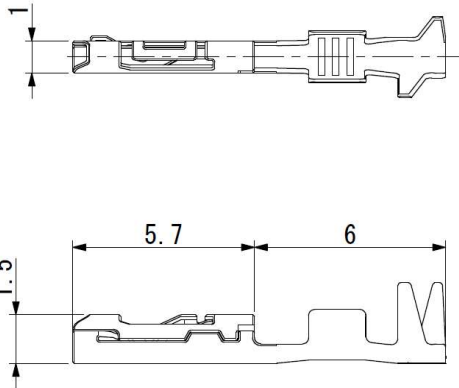

Model No.	Applicable wire range		Q'ty/reel
	Conductor (mm ²)	Insulation O.D. (mm)	
SWMC-A011T-0.5	0.22 to 0.35	1.0 to 1.2	10,000
Material and Finish			
Copper alloy, tin-plated			

Female connector

● 2 circuits

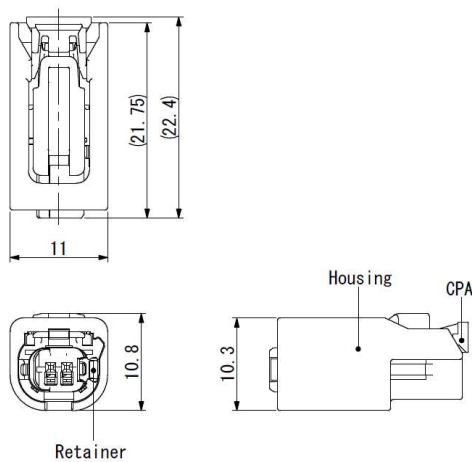

● 8 circuits

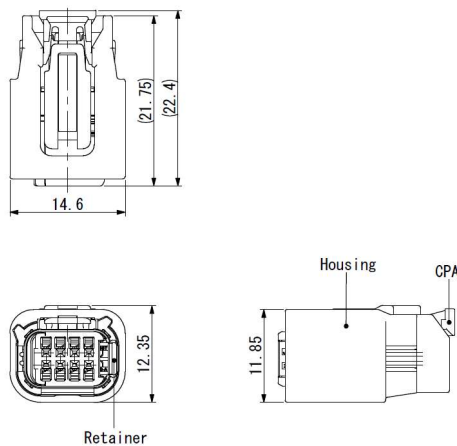

Circuits	Model No.	Housing Color	Q'ty/box
2	02WMC-RSBC-VM-1A-NA-A	Natural	250
	02WMC-RSBC-VM-1A-K-B	Black	250
8	08WMC-RSDBC-VM-1A-NA-A	Natural	180
	08WMC-RSDBC-VM-1A-K-B	Black	180
Material			

Housing : Glass-filled PBT, Natural / Black (UL94 V-0)
 Retainer : Glass-filled PBT, Natural (UL94 V-0)
 CPA : Glass-filled PBT, Green (UL94 V-0)

Note: Contact JST for details.

Male terminal

● Male terminal M

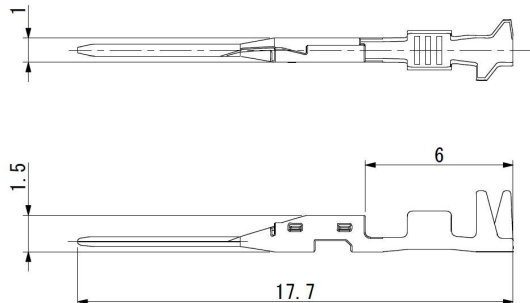

Model No.	Applicable wire range		Q'ty/reel
	Conductor (mm ²)	Insulation O.D. (mm)	
SWMCW-A011T-0.5	0.22 to 0.35	1.0 to 1.2	10,000

Material and Finish

Copper alloy, tin-plated

Male connector

● 2 circuits

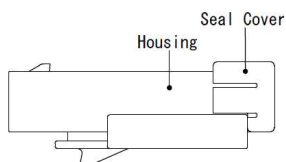
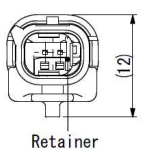
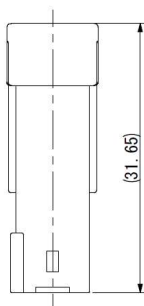

● 8 circuits

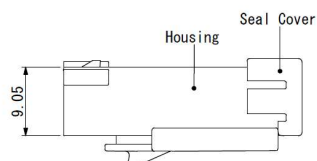
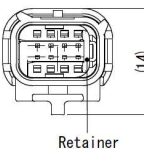
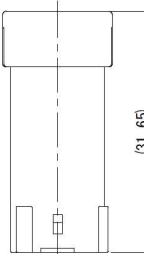

Circuits	Model No.	Housing Color	Q'ty/box
2	02WMC-PSB-VM-1A-NA-A	Natural	200
	02WMC-PSB-VM-1A-K-B	Black	200
8	08WMC-PSDB-VM-1A-NA-A	Natural	120
	08WMC-PSDB-VM-1A-K-B	Black	120

Material

Housing : Glass-filled PBT Natural / Black (UL94 V-0)
 Retainer : Glass-filled PBT, Gray (UL94 V-0)
 Seal Cover : Glass-filled PBT, Black (UL94 V-0)

Note: Contact JST for details.

Dummy plug

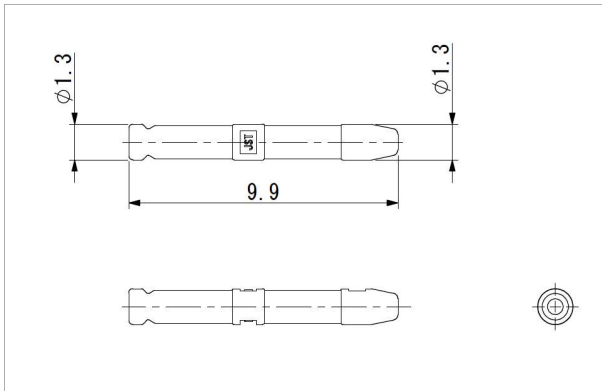

Model No.	Q'ty/box
WMCDP-V-1A-H	7,000
Material	
Glass-filled PBT, Gray	

Assembly layout

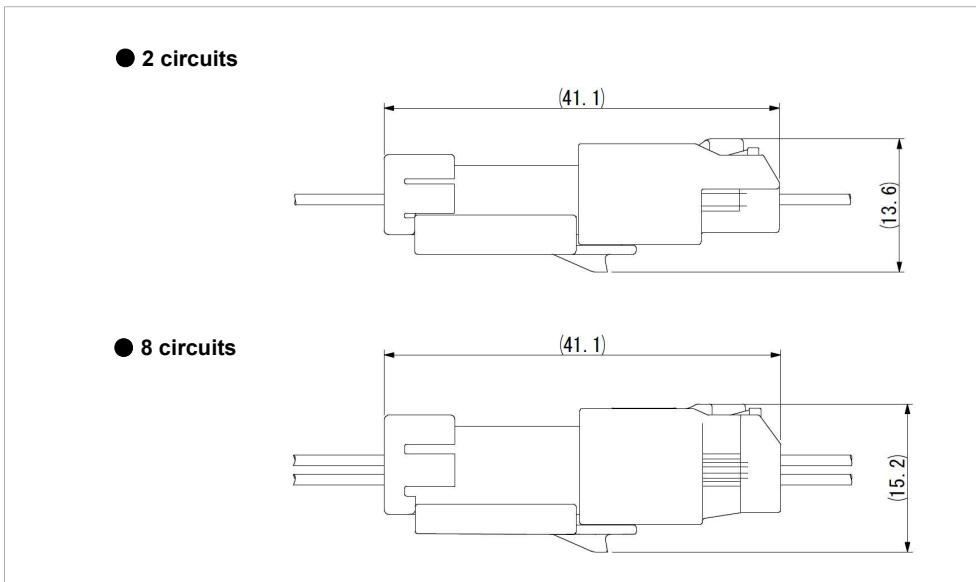

Clip Layout

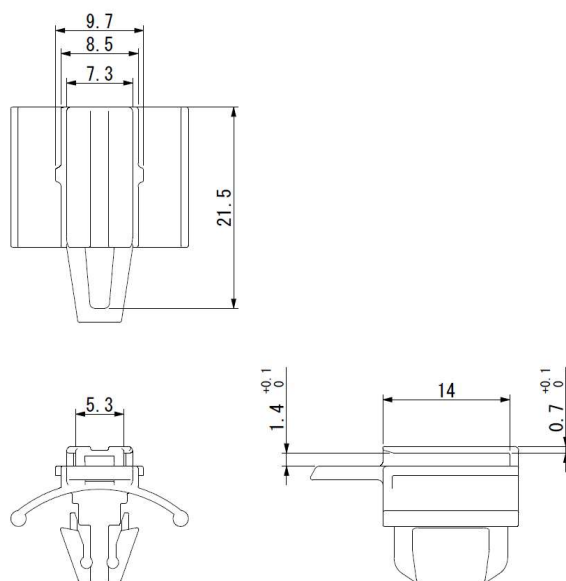

Recommended clip layout

Note: The dimensions above should serve as guideline. Contact JST for details.

Crimping machine, Applicator

Strip terminal	Crimping machine	Crimp applicator MKS-L	
		Dies	Crimp applicator with dies
SWMC-A011T-0.5	AP-K2N	MK/SWMC-A011-05	APLMK SWMC-A011-05
SWMCW-A011T-0.5	AP-K2N	MK/SWMCW-A011-05	APLMK SWMCW-A011-05

Note: 1. Contact JST for details.

2. When crimping operation is conducted using an applicator and die set other than the above, JST cannot guarantee the performance of the terminal.